

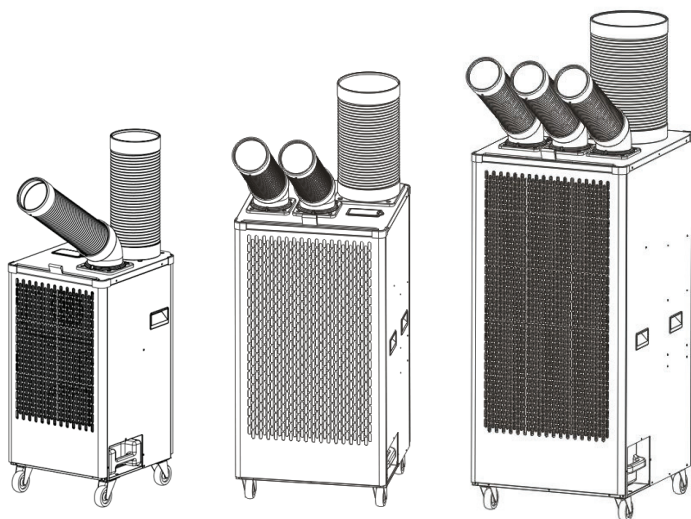

FANMASTER

COOLING HEATING VENTILATION EXTRACTION

INSTRUCTION MANUAL



INDUSTRIAL PORTABLE AIR CONDITIONERS

MODEL: IAC-27, IAC-45, IAC-65

FOR INDUSTRIAL USE ONLY

TO PREVENT SERIOUS INJURY, READ & UNDERSTAND ALL WARNINGS & INSTRUCTIONS BEFORE USE. PLEASE KEEP THIS DOCUMENT FOR YOUR RECORDS

FOR YOUR INFORMATION

Thank you for purchasing a Fanmaster portable air conditioner. Please read this instruction manual carefully before using this heater.

Disclaimer:

Fanmaster reserves the right to make alterations to specifications, quantities, dimensions, for production or other reasons, subsequent to publication.

While we believe the information is accurate and complete, we make no warranty or representation for any particular purposes. The information is offered in good faith and with the understanding that any use of the units or accessories in breach of the directions and warnings in this document is at the sole discretion and risk of the user

Disposal Guidelines:

Do not dispose of this product with general household waste. This product must be disposed according to the laws governing Waste Electrical and Electronic Equipment. If required, contact your local authorities for information regarding the available disposal facilities.



1. GENERAL SAFETY RULES & WARNINGS



- PLEASE READ INSTRUCTIONS CAREFULLY.
- PLACE INSTRUCTION MANUAL IN A SAFE PLACE FOR FUTURE REFERENCE. DO NOT ALLOW ANYONE WHO HAS NOT READ THESE INSTRUCTIONS TO ASSEMBLE, ADJUST OR OPERATE THIS APPLIANCE.
- IF THE INFORMATION IN THIS MANUAL IS NOT FOLLOWED EXACTLY, A FIRE OR EXPLOSION MAY RESULT IN CAUSING PROPERTY DAMAGE, SERIOUS INJURY OR LOSS OF LIFE.
- FAILURE TO COMPLY WITH THE PRECAUTIONS AND INSTRUCTIONS PROVIDED WITH THIS APPLIANCE, CAN RESULT IN DEATH, SERIOUS INJURY AND PROPERTY LOSS OR DAMAGE FROM HAZARDS OF FIRE, EXPLOSION, BURN, ASPHYXIATION, CARBON MONOXIDE POISONING, AND/OR ELECTRICAL SHOCK.
- ONLY PERSONS WHO CAN UNDERSTAND AND FOLLOW THE INSTRUCTIONS SHOULD USE OR SERVICE THIS APPLIANCE. IF YOU NEED ASSISTANCE OR REQUIRE HEATER INFORMATION SUCH AS AN INSTRUCTION MANUAL, LABELS, ETC. CONTACT FANMASTER.
- ADEQUATE VENTILATION IS REQUIRED. DO NOT USE IN ENCLOSED ENVIRONMENTS.
- DO NOT STORE OR USE GASOLINE, PETROL OR ANY OTHER FLAMMABLE OR COMBUSTIBLE VAPORS AND LIQUIDS IN THE VICINITY OF THIS APPLIANCE.
- FIRE, BURN, INHALATION, AND EXPLOSION HAZARD. KEEP SOLID COMBUSTIBLES, SUCH AS BUILDING MATERIALS, PAPER OR CARDBOARD, A SAFE DISTANCE AWAY FROM THE APPLIANCE AS RECOMMENDED BY THE INSTRUCTIONS. NEVER USE THE APPLIANCE IN SPACES WHICH DO OR MAY CONTAIN VOLATILE OR AIRBORNE COMBUSTIBLES, OR PRODUCTS SUCH AS GASOLINE, SOLVENTS, PAINT THINNER, DUST PARTICLES OR UNKNOWN CHEMICALS
- NOT FOR DOMESTIC OR RECREATIONAL VEHICLE USE
- THE ELECTRICAL SYSTEM TO WHICH THE APPLIANCE IS CONNECTED MUST COMPLY WITH LOCAL REGULATIONS. A RESIDUAL-CURRENT DEVICE (RCD) MUST BE INSTALLED.
- UNPLUG THE APPLIANCE BEFORE PERFORMING ANY MAINTENANCE OPERATIONS.
- ALWAYS CHECK THE POWER CABLE BEFORE USING THE APPLIANCE. IT MUST NOT BE BENT, TAUT, STRETCHED, CRUSHED OR ANY WAY DAMAGED.
- IF THE POWER CORD AND/OR PLUG IS DAMAGED, IT MUST BE REPLACED BY FANMASTER, A SERVICE AGENT OR A QUALIFIED PERSONS.
- THE EXHAUST OUTLET IS VERY HOT DURING OPERATION. DO NOT TOUCH! BURN DANGER.
- DO NOT LEAVE THE APPLIANCE UNATTENDED WHEN IN USE.
- NEVER USE THE APPLIANCE WITH WET HANDS OR WHEN EITHER THE APPLIANCE OR THE POWER CABLE IS WET.
- CHILDREN SHOULD BE SUPERVISED TO ENSURE THAT THEY DO NOT PLAY WITH THE APPLIANCE.
- THE APPLIANCE IS NOT INTENDED FOR USE BY PERSONS (INCLUDING CHILDREN) WITH REDUCED PHYSICAL, SENSORY OR MENTAL CAPABILITIES, OR LACK OF EXPERIENCE & KNOWLEDGE.

2. PRODUCT DESCRIPTION & SPECIFICATIONS

PRODUCT DESCRIPTION

Industrial portable air conditioner, cooling only.

<https://www.fanmaster.com.au/product/industrial-portable-air-conditioner-2-7kw-240v/>
<https://www.fanmaster.com.au/product/industrial-portable-air-conditioner-4-5kw-240v/>
<https://www.fanmaster.com.au/product/industrial-portable-air-conditioner-6-5kw-240v/>

SPECIFICATIONS

MODEL	IAC-27	IAC-45	IAC-65
Cooling Output*	2.7KW 9,200 BTU	4.5KW 15,300 BTU	6.5KW 22,000 BTU
Air Flow (L/s)	111	222	333
Rated Power	0.95KW	2.0KW	3.3KW
Voltage (V/Hz)	AC220-240V/50	AC220-240V/50	AC220-240V/50
Current Rating (A)	4.2	9.0	1.5
Plug Connection	3 Pin 10amp	3 Pin 15amp	3 Pin 15amp
Refrigerant	R410A	R410A	R410A
Refrigerant Charge	460 grams (+/- 10g)	800 grams (+/- 10g)	1050 grams (+/- 10g)
No. of Cool Air Duct	1	2	3
Cooling Duct Dia (mm)	120	120	120
Exhaust Duct Dia (mm)	160	200	250
Fan Speed	2	2	2
Noise (dBa)	55	60	65
Condensation Tank (L)	5	8	13
Net Weight (kg) N/G	42 / 47	70 / 75	94 / 150
Product Dimensions (mm)	(W)405x(D)430x(H)855	(W)520x(D)480x(H)1035	(W)630x(D)560x(H)1245
Packaged Dimensions (mm) 1	(W)484 x (D)515 x (H)965	(W)570x(D)610x(H)1110	(W)720x(D)650x(H)1350
Packaged Dimensions (mm) 1	-	(W)260x(D)350x(H)370	(W)380x(D)280x(H)515

SAFETY DEVICES:

- **Compressor Overheat & Overload Protection** - power will be cut off if the compressor overheats or there is high or low voltage .

3. GETTING TO KNOW YOUR APPLIANCE

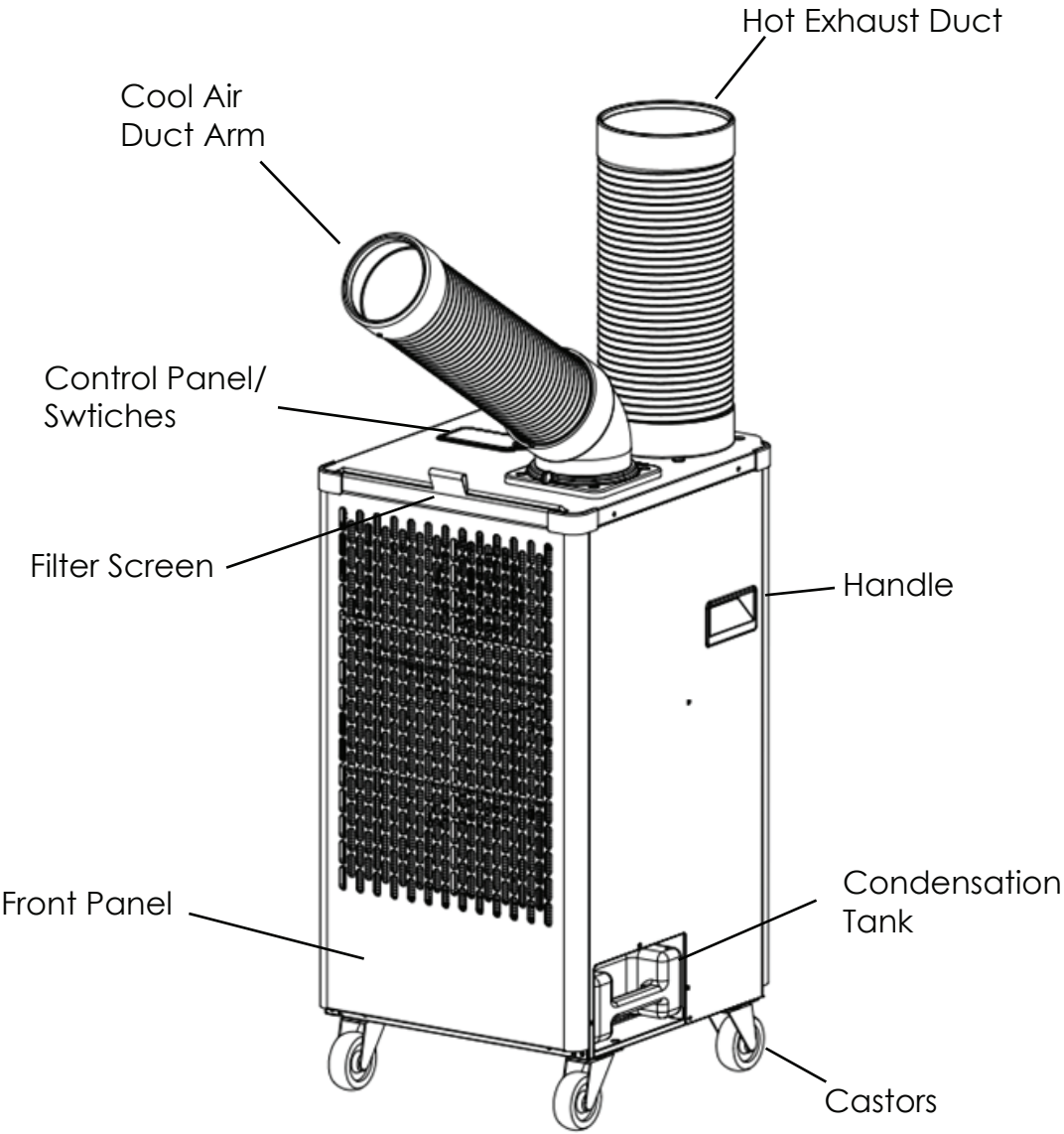

4. ASSEMBLY/INSTALLATION

ATTACHING THE COOL DUCT & ELBOW

- Elbow - attach elbow to the base plate (on the machine) by inserting the attach point of the elbow into the base plate and rotate it anticlockwise. You will hear a click.
- Cool Duct - insert the attach point to the top of the elbow and rotate it anticlockwise.

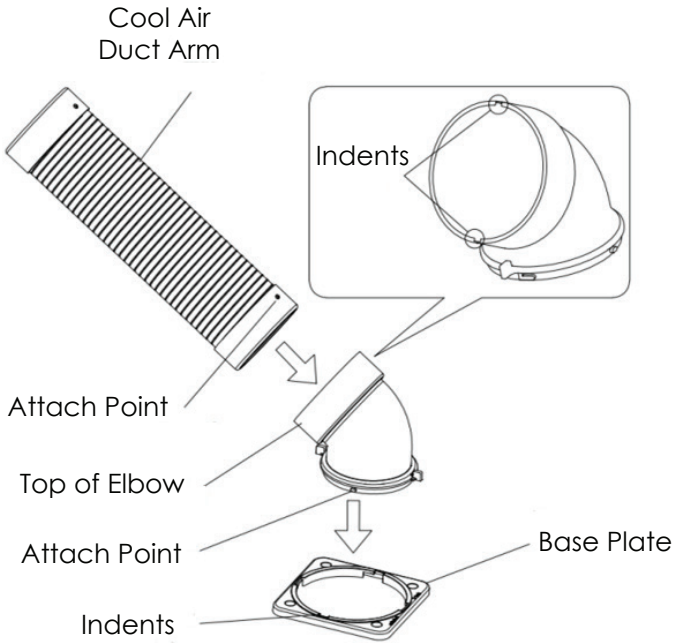

ATTACHING THE HOT EXHAUST DUCT

- Attach hot exhaust duct on to the heat vent on the machine.

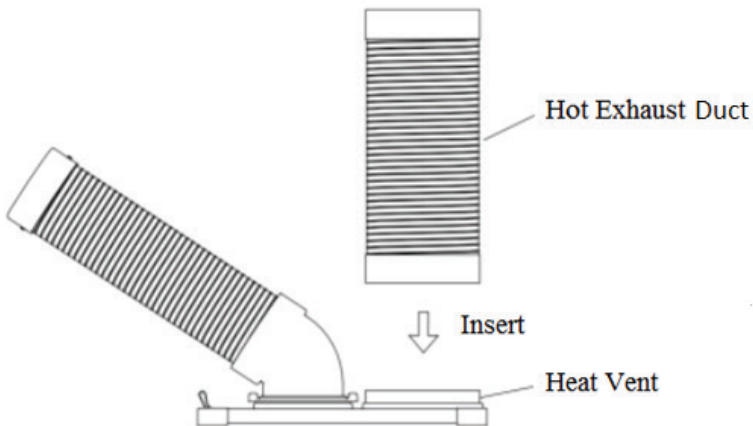

4. OPERATING INSTRUCTIONS

TURN ON & OFF

- Rotate the selector switch to setting 1  or 2 , the compressor will turn on.
- To turn the appliance off, rotate the selector switch to "0".

Always to turn the appliance off from the switch on the appliance before unplugging it from the power source.

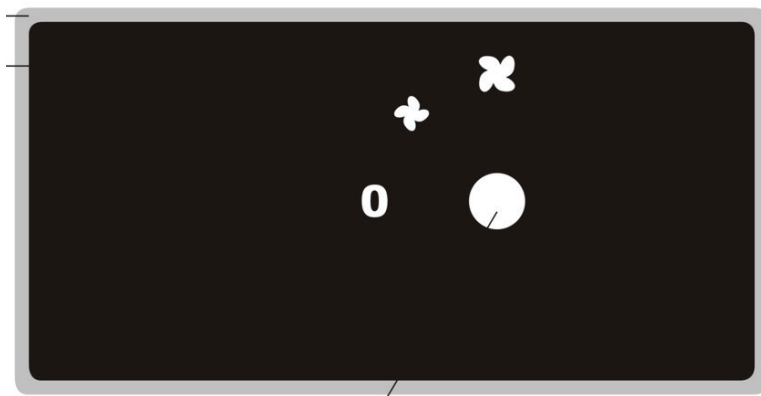

ADJUSTING THE COOL DUCT ARMS & EXHAUST DUCT

- Cool duct arms can rotate left or right to 360 degrees
- Cold duct arms can be moved up or down to 150 degrees

When adjusting the cool duct arms, grip the elbow then make the adjustments.

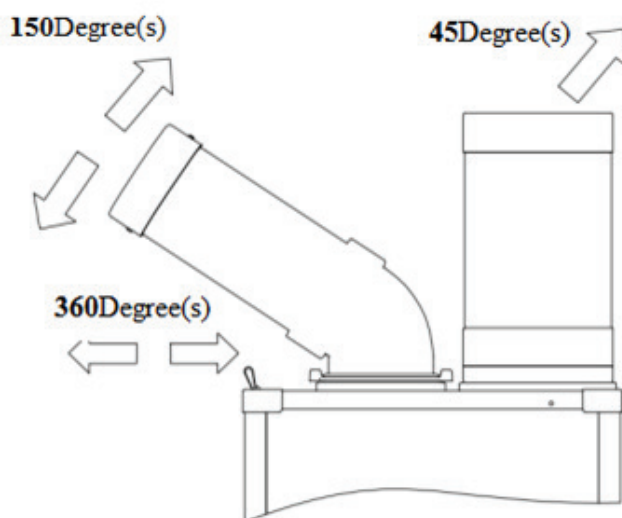

4. OPERATING INSTRUCTIONS - CONTINUED

WATER TANK

- When the water tank is full, the appliance will stop operating. Turn selector switch to "0", remove water tank and empty.

OTHER

- When the appliance is running, both the filter screen and the cool duct arms shall be 30cm or more away from the wall or other obstacles, and the hot exhaust pipe shall be 80cm or more from the roof or obstacle.
- Position the appliance so it stands upright and is on a firm/flat surface.
- It is prohibited to use it in rain, snow and other humid sites.
- Please do not place obstacle in front of the filter screen or air outlet of the cold air pipe and the hot exhaust pipe. Please do not point the hot air from the hot exhaust pipe to articles with poor heat resistance.

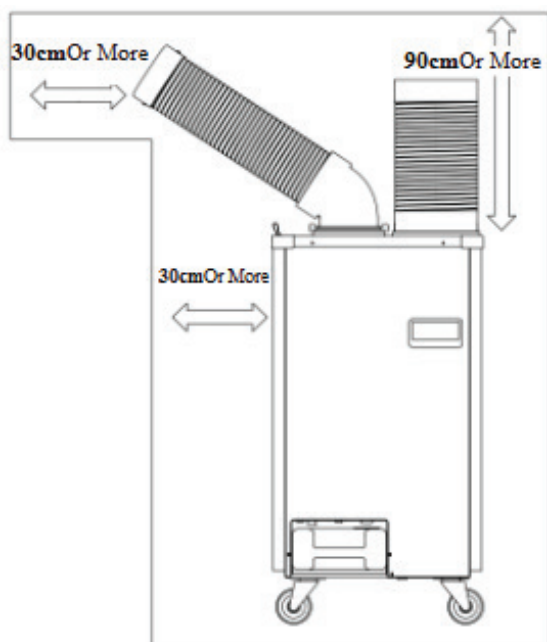

5. CLEANING, MAINTENANCE & STORAGE

- Before starting any maintenance task, shut down, unplug and let the appliance cool down for at least 15 minutes.
- Do not attempt any electrical repair yourself. If the appliance needs service or repair, contact a qualified person.
- When cleaning, make sure that water does not enter the unit.
- Do not open the enclosure to clean the inner parts. Do not spray water into the appliance.
- Never use solvents, gasoline, toluene and similar aggressive chemicals to clean the heater.

Regularly wipe the enclosure using a soft sponge or cloth. For very dirty parts, use a sponge wetted with lukewarm water and a mild detergent, then dry using a clean cloth.

Clean the filters (black) on a regular basis. Use a vacuum cleaner to remove the dust and use clean water to wash it. Ensure the filter screens are dry before using the appliance.

Check the power cord and plug for any damages, if damaged replace the cord or plug immediately by a qualified person only.

STORAGE

- Remove any water from the condensation tank.
- Ensure the appliance is standing upright, do not place it horizontally or upside down.
- Ensure it is stored inside in a dry area.

6. WIRING DIAGRAM

IAC-27

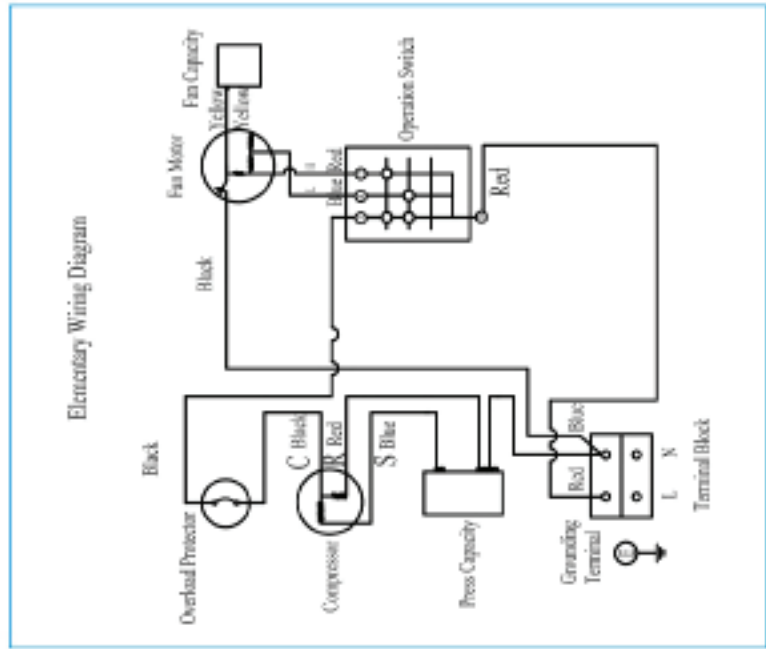

IAC-45 & IAC-65

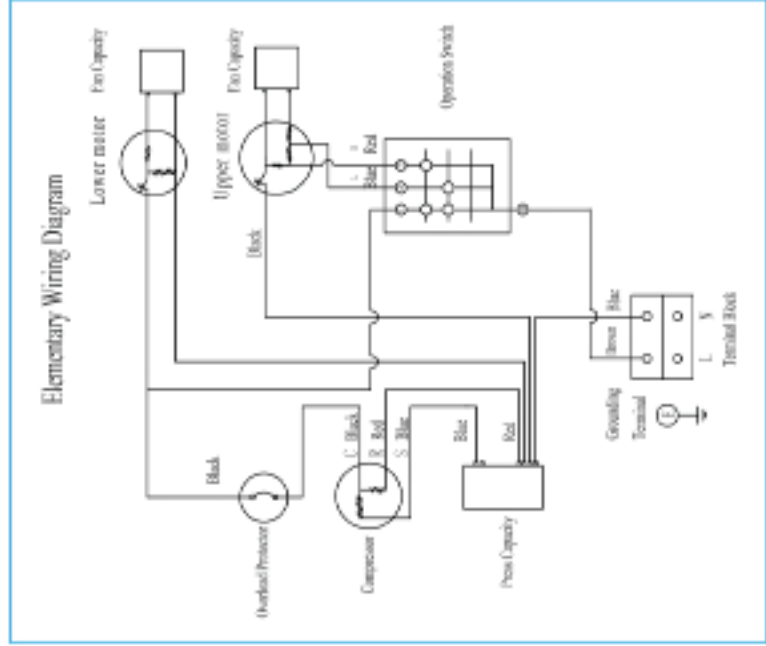

7. TROUBLESHOOTING

PROBLEM	CAUSE	SOLUTION
No Power	Plug is loose or not connected correctly	Check plug connection
	Faulty or damaged power cord	Check & replace
	Fuse is burnt	Check & replace
No Cool Air	Condensor is blocked	Clean condensor and filters. Let it cool down.
	Exhaust fan failed	Replace fan motor
	External temperature is too high	
	Compressor capacitor is faulty	Replace capacitor
	Refrigerant leak	Find leak and refill refrigerant gas.
	High or low voltage	Check voltage supply
	Compressor overheat & overload protection fails	Restart after cooling min 3 minutes
	Compressor fails	Repair or replace compressor
Water Leakage	Drain pipe is clogged	Clean out drain pipe
	Water tank is not positioned correctly	Reset it
	Filter screen is blocked	Clean filter screens
	Water tank is full	Remove water from tank

8. WARRANTY

Any claim under this warranty must be made within 12 months of the date of purchase of the product. To make a claim under the warranty, take the product (with proof of purchase) to the store where you purchased the product or go to <https://www.fanmaster.com.au/support>.

This warranty is given by Fanmaster Pty Ltd
ABN: 45 353 934 457
Unit 1/6-8 Yalgar Rd, KIRRAWEE NSW 2232
P: 1300 900 345
E: support@fanmaster.com.au

This warranty is provided in addition to other rights and remedies you have under law: Our goods come with guarantees which cannot be excluded under the Australian Consumer Law. You are entitled to replacement or refund for a major failure and to compensation for other reasonably foreseeable loss or damage. You are also entitled to have the goods repaired or replaced if the goods fail to be of acceptable quality and the failure does not amount to a major failure.

Exclusions: This warranty does not cover:

- Any defects caused by an accident, misuse, abuse, improper installation or operation, lack of reasonable care, unauthorized modification, loss of parts, tampering or attempted repair by a person not authorized by the distributor.
- Any product that has not been installed, operated or maintained to a satisfactory level.
- Any damage caused by improper power input or improper cable connection.

9. WARRANTY VALIDATION

Register Your Product

> **Warranty Management**

Validate your warranty, and receive notification 14 days prior to expiration.

> **Warranty Extension Available**

Add extended warranty to give you peace of mind.

> **Product Updates**

Latest news and updates on Fanmaster products.



REGISTER

www.fanmaster.com.au/warranty-registration



Fanmaster Pty Ltd | 1/6-8 Yalgar Road, KIRRAWEE NSW 2232
1300 900 345 | sales@fanmaster.com.au | www.fanmaster.com.au



N11664
MADE IN CHINA